

Technical Specification VSB-36 Series



Self-Lubricating Bearings

Stainless Steel backed with PTFE fabric lining bushing

viplus

Stainless steel backed with PTFE woven fabric lining bushing

Description

The material is made of high-quality metals, and the surface is covered with PTFE woven fabric. Which are low friction and friction-resistant fabric materials. This material structure has a higher carrying capacity, high-temperature resistance, and **longer service life than the general three-layer composite material** . Stainless steel backed bushings offers a standard assortment of plain cylindrical bushings according to ISO 3547 and DIN 1494. This Woven Glide Bushing main features are wear resistance and corrosion resistance, high load bearing than DU/DUB bushing



Applications



Hydro



Offshore



Marine

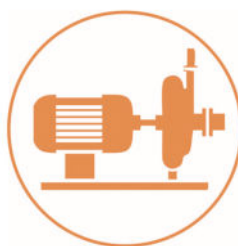

Pump



Valve

Advantages

- Excellent resistance to corrosive conditions
- Very good frictional properties
- Maintenance-free operation
- High load capacity
- 7-8 times longer life than DU/DUB

Technical data

Max. Load	Static	340 Nmm ²
	Dynamic	180 N/mm ²
Max. speed	Dry	0.5 m/s
	Lubrication	>1 m/s
Max. PV (Dry)	Short-term	3.6 N/mm ² × m/s
	Continuous	1.8 N/mm ² × m/s
Coefficient of Friction		0.03 to 0.20
Temperature		-50 °C to +250 °C
Coefficient of thermal expansion		11 X 10 ⁻⁶ k ⁻¹
Thermal conductivity		42W(m.k) ⁻¹

Application recommendations

Shaft tolerance g6 – f7

Housing tolerance H7

Shaft roughness Ra, µm 0 .. 0,4

Shaft hardness, HB 300 – 600

Availability

Plain cylindrical, Fanged, Thrust washers, Strips, Plates and customized
Dimensions similar as three layered coiled bushing.

Wall thickness 1mm, 1.5mm, 2mm and 2.5mm

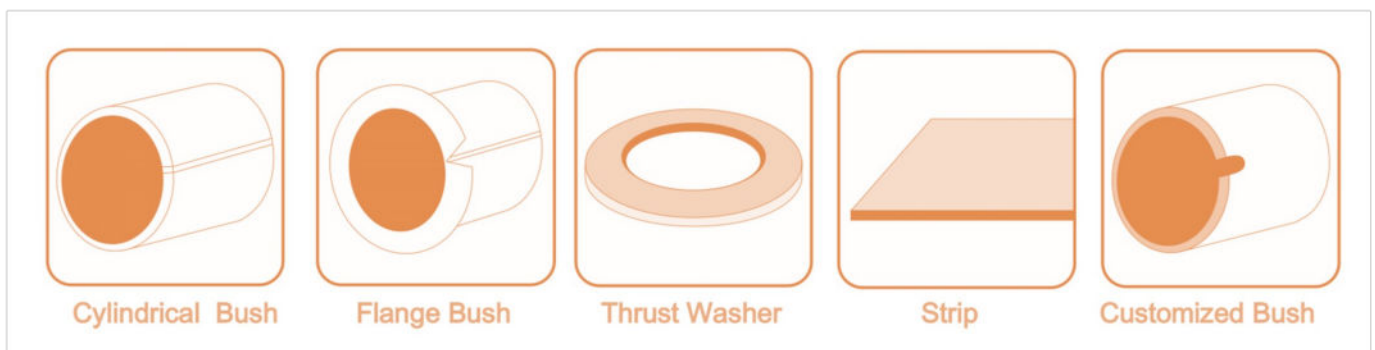

Cylindrical bush standard metric dimensions :

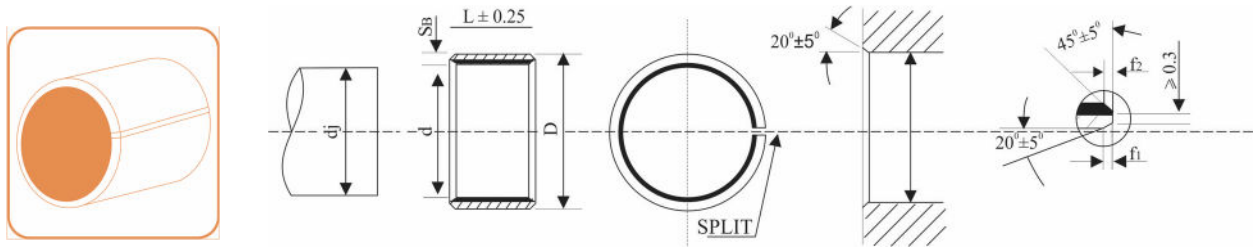

Order Code	Dimension		
	OD	ID	LG
VSΒ-36 - 1006	12	10	6
VSΒ-36 - 1008	12	10	8
VSΒ-36 - 1010	12	10	10
VSΒ-36 - 1012	12	10	12
VSΒ-36 - 1015	12	10	15
VSΒ-36 - 1020	12	10	20
VSΒ-36 - 1206	14	12	6
VSΒ-36 - 1208	14	12	8
VSΒ-36 - 1210	14	12	10
VSΒ-36 - 1212	14	12	12
VSΒ-36 - 1215	14	12	15
VSΒ-36 - 1220	14	12	20
VSΒ-36 - 1225	14	12	25
VSΒ-36 - 1310	15	13	10
VSΒ-36 - 1320	15	13	20
VSΒ-36 - 1410	16	14	10
VSΒ-36 - 1412	16	14	12
VSΒ-36 - 1415	16	14	15
VSΒ-36 - 1420	16	14	20
VSΒ-36 - 1425	16	14	25
VSΒ-36 - 1510	17	15	10
VSΒ-36 - 1512	17	15	12
VSΒ-36 - 1515	17	15	15
VSΒ-36 - 1520	17	15	20
VSΒ-36 - 1525	17	15	25
VSΒ-36 - 1610	18	16	10
VSΒ-36 - 1612	18	16	12
VSΒ-36 - 1615	18	16	15
VSΒ-36 - 1620	18	16	20
VSΒ-36 - 1625	18	16	25

Order Code	Dimension		
	OD	ID	LG
VSΒ-36 - 17 10	19	17	10
VSΒ-36 - 1712	19	17	12
VSΒ-36 - 1720	19	17	20
VSΒ-36 - 1810	20	18	10
VSΒ-36 - 1812	20	18	12
VSΒ-36 - 1815	20	18	15
VSΒ-36 - 1820	20	18	20
VSΒ-36 - 1825	20	18	25
VSΒ-36 - 2010	23	20	10
VSΒ-36 - 2012	23	20	12
VSΒ-36 - 2015	23	20	15
VSΒ-36 - 2020	23	20	20
VSΒ-36 - 2025	23	20	25
VSΒ-36 - 2030	23	20	30
VSΒ-36 - 2210	25	22	10
VSΒ-36 - 2212	25	22	12
VSΒ-36 - 2215	25	22	15
VSΒ-36 - 2220	25	22	20
VSΒ-36 - 2225	25	22	25
VSΒ-36 - 2230	25	22	30
VSΒ-36 - 2415	27	24	15
VSΒ-36 - 2420	27	24	20
VSΒ-36 - 2425	27	24	25
VSΒ-36 - 2430	27	24	30
VSΒ-36 - 2510	28	25	10
VSΒ-36 - 2512	28	25	12
VSΒ-36 - 2515	28	25	15
VSΒ-36 - 2520	28	25	20
VSΒ-36 - 2525	28	25	25
VSΒ-36 - 2530	28	25	30

Cylindrical bush standard metric dimensions :

Order Code	Dimension		
	OD	ID	LG
VS36-36 - 2540	28	25	40
VS36-36 - 2520	28	25	50
VS36-36 - 2815	32	28	15
VS36-36 - 2820	32	28	20
VS36-36 - 2820	32	28	20
VS36-36 - 2830	32	28	30
VS36-36 - 2840	32	28	40
VS36-36 - 3012	34	30	12
VS36-36 - 3015	34	30	15
VS36-36 - 3020	34	30	20
VS36-36 - 3025	34	30	25
VS36-36 - 3030	34	30	30
VS36-36 - 3040	34	30	40
VS36-36 - 3220	36	32	20
VS36-36 - 3230	36	32	30
VS36-36 - 3240	36	32	40
VS36-36 - 3512	39	35	12
VS36-36 - 3515	39	35	15
VS36-36 - 3520	39	35	20
VS36-36 - 3525	39	35	25
VS36-36 - 3530	39	35	30
VS36-36 - 3540	39	35	40
VS36-36 - 3550	39	35	50
VS36-36 - 3815	42	38	15
VS36-36 - 3830	42	38	30
VS36-36 - 3840	42	38	40
VS36-36 - 4012	44	40	12
VS36-36 - 4020	44	40	20
VS36-36 - 4025	44	40	25
VS36-36 - 4030	44	40	30
VS36-36 - 4040	44	40	40
VS36-36 - 4050	44	40	50
VS36-36 - 4520	50	45	20
VS36-36 - 4525	50	45	25
VS36-36 - 4530	50	45	30
VS36-36 - 4540	50	45	40
VS36-36 - 4550	50	45	50

Order Code	Dimension		
	OD	ID	LG
VS36-36 - 5020	55	50	20
VS36-36 - 5030	55	50	30
VS36-36 - 5040	55	50	40
VS36-36 - 5050	55	50	50
VS36-36 - 5060	55	50	60
VS36-36 - 5530	60	55	30
VS36-36 - 5540	60	55	40
VS36-36 - 5550	60	55	50
VS36-36 - 5560	60	55	60
VS36-36 - 6030	65	60	30
VS36-36 - 6040	65	60	40
VS36-36 - 6050	65	60	50
VS36-36 - 6060	65	60	60
VS36-36 - 6070	65	60	70
VS36-36 - 6530	70	65	30
VS36-36 - 6540	70	65	40
VS36-36 - 6550	70	65	50
VS36-36 - 6560	70	65	60
VS36-36 - 6570	70	65	70
VS36-36 - 7040	75	70	40
VS36-36 - 7050	75	70	50
VS36-36 - 7060	75	70	60
VS36-36 - 7070	75	70	70
VS36-36 - 7080	75	70	80
VS36-36 - 7530	80	75	30
VS36-36 - 7540	80	75	40
VS36-36 - 7550	80	75	50
VS36-36 - 7560	80	75	60
VS36-36 - 7570	80	75	70
VS36-36 - 7580	80	75	80
VS36-36 - 8040	85	80	40
VS36-36 - 8050	85	80	50
VS36-36 - 8060	85	80	60
VS36-36 - 8070	85	80	70
VS36-36 - 8080	85	80	80
VS36-36 - 80100	85	80	100
VS36-36 - 8540	90	85	40

Cylindrical bush standard metric dimensions :

Order Code	Dimension		
	OD	ID	LG
VS36-36 - 8560	90	85	60
VS36-36 - 8580	90	85	80
VS36-36 - 85100	90	85	100
VS36-36 - 9040	95	90	40
VS36-36 - 9050	95	90	50
VS36-36 - 9060	95	90	60
VS36-36 - 9080	95	90	80
VS36-36 - 90100	95	90	100
VS36-36 - 9550	100	95	50
VS36-36 - 9560	100	95	60
VS36-36 - 9580	100	95	80
VS36-36 - 95100	100	95	100
VS36-36 - 10050	105	100	50
VS36-36 - 10060	105	100	60
VS36-36 - 10080	105	100	80
VS36-36 - 100115	105	100	115
VS36-36 - 10560	110	105	60
VS36-36 - 10580	110	105	80
VS36-36 - 105115	110	105	115
VS36-36 - 11060	115	110	60
VS36-36 - 11080	115	110	80
VS36-36 - 110115	115	110	115
VS36-36 - 12060	125	120	60
VS36-36 - 12080	125	120	80
VS36-36 - 120100	125	120	100
VS36-36 - 12560	130	125	60
VS36-36 - 125100	130	125	100
VS36-36 - 125115	130	125	115
VS36-36 - 13060	135	130	60

Order Code	Dimension		
	OD	ID	LG
VS36-36 - 13080	135	130	80
VS36-36 - 130100	135	130	100
VS36-36 - 14060	145	140	60
VS36-36 - 14080	145	140	80
VS36-36 - 140100	145	140	100
VS36-36 - 15060	155	150	60
VS36-36 - 15080	155	150	80
VS36-36 - 150100	155	150	100
VS36-36 - 16060	165	160	60
VS36-36 - 16080	165	160	80
VS36-36 - 160100	165	160	100
VS36-36 - 160115	165	160	115
VS36-36 - 18080	185	180	80
VS36-36 - 180100	185	180	100
VS36-36 - 19080	195	190	80
VS36-36 - 190100	195	190	100
VS36-36 - 20060	205	200	60
VS36-36 - 20080	205	200	80
VS36-36 - 200100	205	200	100
VS36-36 - 22080	225	220	80
VS36-36 - 220100	225	220	100
VS36-36 - 25080	255	250	80
VS36-36 - 250100	255	250	100
VS36-36 - 26080	265	260	80
VS36-36 - 260100	265	260	100
VS36-36 - 28080	285	280	80
VS36-36 - 280100	285	280	100
VS36-36 - 30080	305	300	80
VS36-36 - 300100	305	300	100

- All dimensions in mm
- Shaft and housing tolerances based on ISO
- Above dimensions are our standard size bushes, but we can supply customize size and design

Flange bush standard metric dimensions :

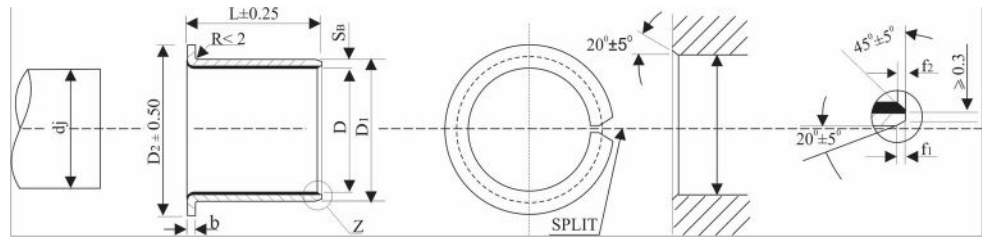
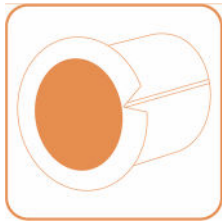

Order Code	Dimension			
	OD	ID	FLG	LG
VSB-36 - F1007	12	10	18	7
VSB-36 - F1009	12	10	18	9
VSB-36 - F1012	12	10	18	12
VSB-36 - F1207	14	12	20	7
VSB-36 - F1209	14	12	20	9
VSB-36 - F1212	14	12	20	12
VSB-36 - F1412	16	14	22	12
VSB-36 - F1417	16	14	22	17
VSB-36 - F1509	17	15	23	9
VSB-36 - F1512	17	15	23	12
VSB-36 - F1517	17	15	23	17
VSB-36 - F1612	18	16	24	12
VSB-36 - F1617	18	16	24	17
VSB-36 - F1620	18	16	24	20
VSB-36 - F2011	23	20	30	11

Order Code	Dimension			
	OD	ID	FLG	LG
VSB-36 - F2016	23	20	30	16
VSB-36 - F2021	23	20	30	21
VSB-36 - F2215	25	22	32	15
VSB-36 - F2220	25	22	32	20
VSB-36 - F2511	28	25	35	11
VSB-36 - F2516	28	25	35	16
VSB-36 - F2521	28	25	35	21
VSB-36 - F3016	34	30	12	16
VSB-36 - F3026	34	30	12	26
VSB-36 - F3516	39	35	47	16
VSB-36 - F3526	39	35	47	26
VSB-36 - F4026	44	40	53	26
VSB-36 - F4026	44	40	53	26
VSB-36 - F4516	50	45	58	16
VSB-36 - F4526	50	45	58	26

Thrust washer standard metric dimensions :

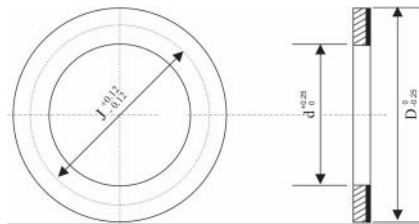
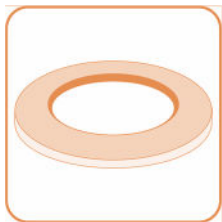

Order Code	Dimension		
	OD	ID	TH
VSB-36 - W10	20	10	1.5
VSB-36 - W12	24	12	1.5
VSB-36 - W14	26	14	1.5
VSB-36 - W16	30	16	1.5
VSB-36 - W18	32	18	1.5
VSB-36 - W20	36	20	1.5
VSB-36 - W22	38	22	1.5
VSB-36 - W24	42	24	1.5

Order Code	Dimension		
	OD	ID	TH
VSB-36 - W26	44	26	1.5
VSB-36 - W28	48	28	1.5
VSB-36 - W32	54	32	1.5
VSB-36 - W38	62	38	1.5
VSB-36 - W42	66	42	1.5
VSB-36 - W48	74	48	2
VSB-36 - W52	78	52	2
VSB-36 - W62	90	62	2

Reliable, economical bearings & wear parts solutions



VIPLUS INTERNATIONAL

Address: No. 555, Chuang Ye Road, Industry Park, Jiashan, Zhejiang
China 314100

Phone: +86 (0)57384499350

Fax: +86 (0)57384499352

Email: viplus@viplus.com

<https://www.viplus.com>

Distributor:

viplus